

Self-Contained Hopper Loaders

Corrosion-free, stainless steel hoppers designed to prevent material contamination

Comet's CAL-U Series self-contained hopper loaders are used to transfer pellets and regrind from a single source (usually a gaylord) to a single destination (usually a blender, drying hopper, or machine throat) in facilities that do not have centralized conveying systems. The cost-efficient, stainless steel hopper ensures contamination free material, and the soundproof motor cover reduces motor noise. The detachable control panel allows the operator the convenience of remote operation.

Standard Features

- Sound-proof, corrosion free stainless steel interior with no internal protrusions.
- Carbon brush motor and fault indicator for a faster rotating speed and commutation.
- User-friendly microprocessor control with a fully programmable, easy-to-read interface with functions for filter cleaning time and frequency, load and delay time, and maintenance scheduling.
- Extremely reliable, highly sensitive reed switch on CAL-U or photosensor switch on CAL-U-E for material level detection.
- Quick release, hinged hopper lid ensures quick cleanup time and easy maintenance.
- CAL-6U and above models can select an air accumulator to enhance purging and reduce manual clean time.
- Detachable hand-held control panel for remote operation.
- Run time indicator, reverse stopper flap, automatic cleaning.
- A pendant can be extended up to 50-ft. by using a standard CAT5 cable.
- Cloth mesh filter and auto-spraying dust cleaner.

Options

- Reinforced auto cleaning air accumulator (model CAL-6U and above).
- Regrind mix ratio works with Comet's CPV-U proportioning valve to enhance mixing.
 - Variable load sequences
 - Visual alarms
- Items include: (1) 10-ft. hose, (2) adjustable clamps, and (1) stainless steel wand.



CAL-6U



CAL-3U-E



CAL-6U-3

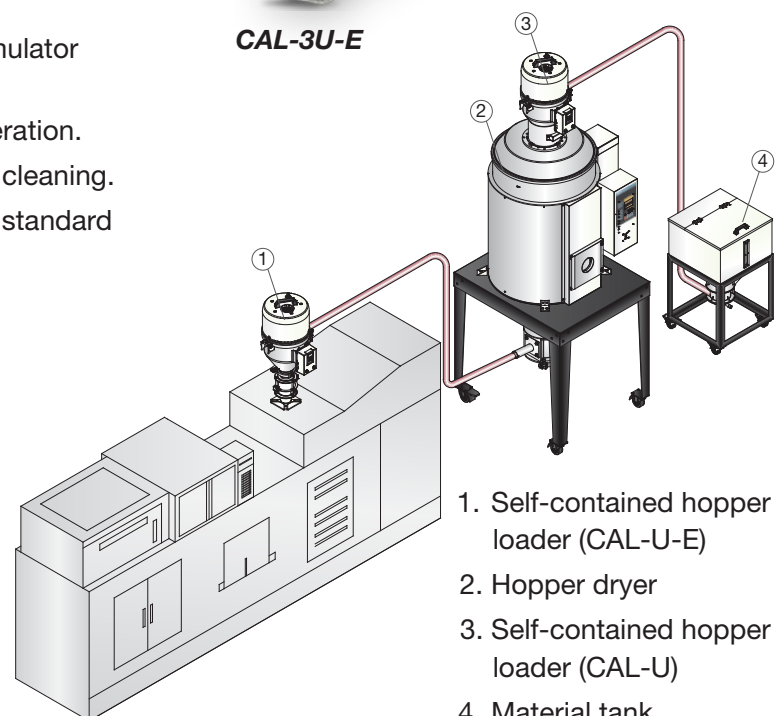

1. Self-contained hopper loader (CAL-U-E)
2. Hopper dryer
3. Self-contained hopper loader (CAL-U)
4. Material tank

Loading Capacity

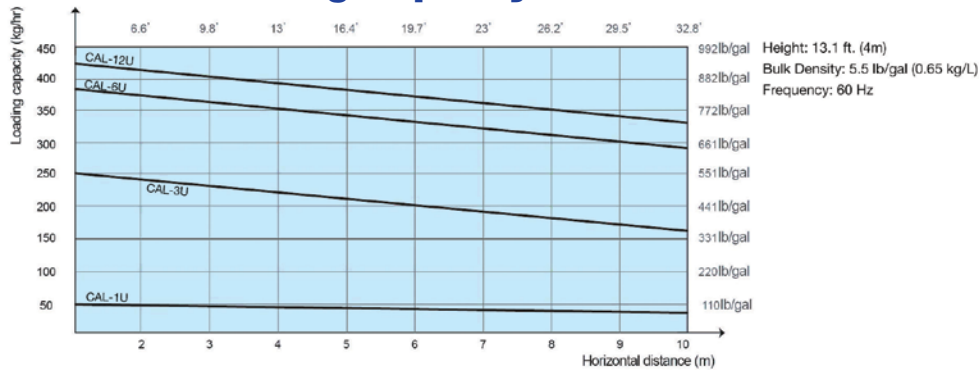

CAL-1U (and above) Hopper Base Installation Size

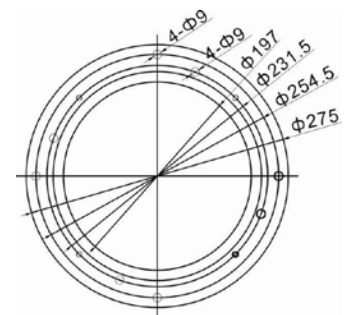

CAL-U-E Hopper Base Installation Size

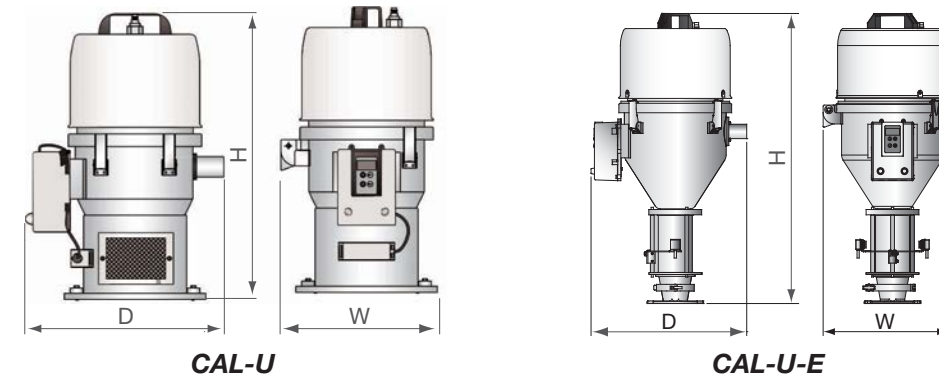
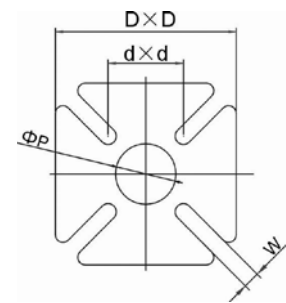

Specifications

Model	CAL-1U	CAL-3U	CAL-6U	CAL-12U	CAL-1U-E	CAL-3U-E	CAL-6U-E	CAL-12U-E
Blower Type	Carbon Brush							
Motor Power (kW) (50/60Hz)	0.46 / 0.55	1.15 / 1.32			0.46 / 0.55	1.15 / 1.32		
Conveying Pipe Internal Dia. (in)	1.5"							
Conveying Capacity (kg/hr.)	30	200	300	400	30	200	300	400
Hopper Volume	1	3	6	12	1.5	3	6	12
Power Supply	1Ø, 115 / 230V, 50/60Hz							
Auto-Cleaning Function	Standard							
Air Accumulator	None		Optional		None		Optional	

Dimensions

H	(inch)	20.7	21.8	25.4	29.3	24.8	29.1	31.5	36.8
	(mm)	525	555	645	745	630	740	800	935
W	(inch)	10.6	12	13.4	13.4	10.2	12	13.4	13.4
	(mm)	270	305	340	340	260	305	340	340
D	(inch)	12.8	14.6	16.1	16.1	12.8	14.6	16.1	16.1
	(mm)	325	370	410	410	325	370	410	410
Weight	(lb)	22	24.3	26.5	30.9	24.3	28.7	35.3	39.7
	(kg)	10	11	12	14	11	13	16	18

Note: Conveying Capacity Test Conditions:

1. Bulk density of plastic material: 5.5 lb/gal. (0.65kg/L)
2. Diameter: 0.12~2 inch (3~5mm)
3. Vertical conveying height: 13.1 ft. (4m)
4. Horizontal conveying distance: 3.28 ft. (1m)
5. Compressed air supply: 4~6 kgf/cm²

We reserve the right to change specifications without prior notice.