

## Gravimetric Blenders

***A state-of-the-art, cost-effective gravimetric blender for direct mounting on injection molding, blow molding and extrusion machines.***

Comet's CGB series gravimetric blender provides even mixing, accurate weighing, and can precisely mix several types of material simultaneously. It can be installed on extrusion lines, injection molding machines, and blow molding machines. The machine is controlled by an advanced microprocessor with a digital display that is simple to calibrate. The self-compensation and calibration function ensures accurate material percentages.

Load material hoppers with regrind, natural, color, and additive, then set the recipe percentage for each material. Once the gravimetric blender is running, it will precisely weigh out each material according to the recipe.

### Standard Features

- Micro-scale metering accuracy of  $\pm 0.1\%$  when all material is blended using gravity.
- The auto calibration function performs every time material is weighed ensuring precise proportioning accuracy.
- The machine base features a magnet and manual side gate.
- Models CGB-600 and below are directly mounted on the machine.
- Models CGB-1200 and above are equipped with a floor stand, material storage tank, and pneumatic discharge valve.
- Easy to clean with accessible components and a large maintenance door.
- 100 recipes can be stored for future use.
- Audible and visual alarms with an alarm history screen.
- Ethernet communication function centrally monitors the operation when connected to a molding machine.

### Options

- Low material level sensor for storage hopper provides advance warning for material shortage.
- Vacuum generator and central hopper receiver.
- Microscale pulse metering valve for CGB-40/200/600 to meter materials with proportions of 0.2% - 0.5%.
- Special material metering valve for metering sheets and irregular materials with diameters of .5 x .5 x .5 inches.
- Data collection function can read additive proportions, outputs, all kinds of materials' total amounts and output rate of every lot of virgin or recycling material, color concentrate, and additives.
- Recycled material auto-compensation function.



**CGB-200-4**  
**(Machine Mount)**

# CGB Series

## Application

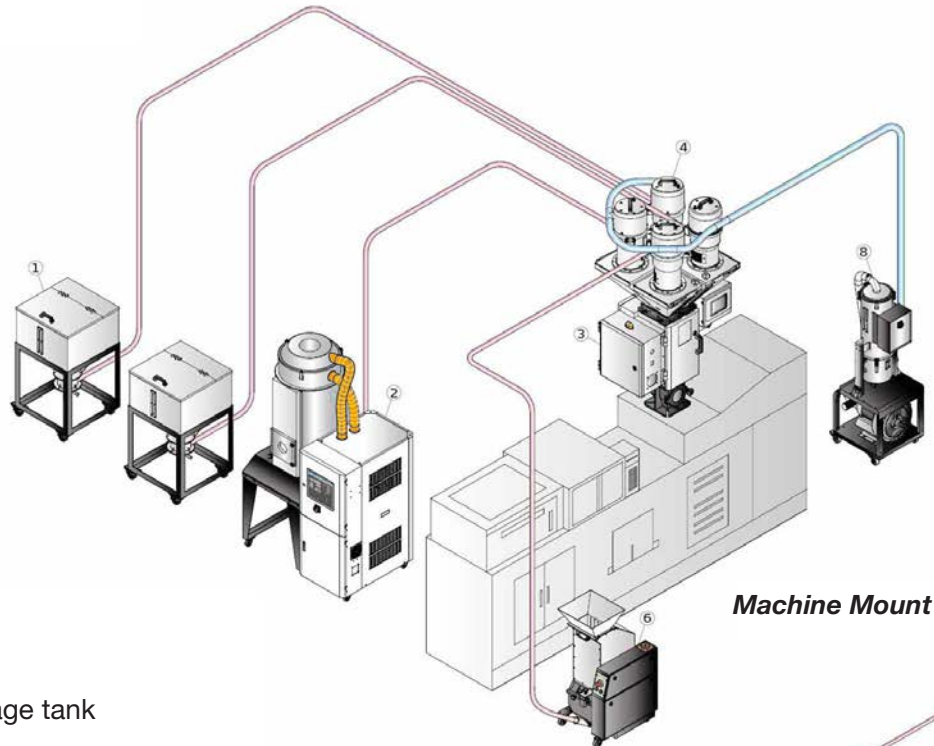

1. Material storage tank
2. Dehumidifying dryers
3. Gravimetric blenders
4. Vacuum hopper
5. Separate hopper loader
6. Low speed granulators
7. Photosensor hopper
8. Vacuum unit

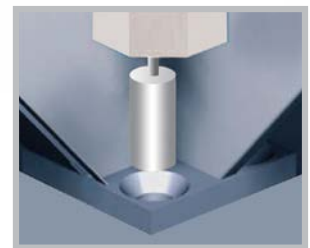
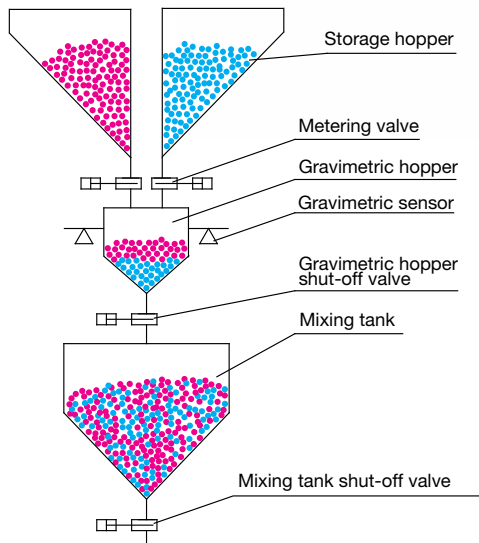
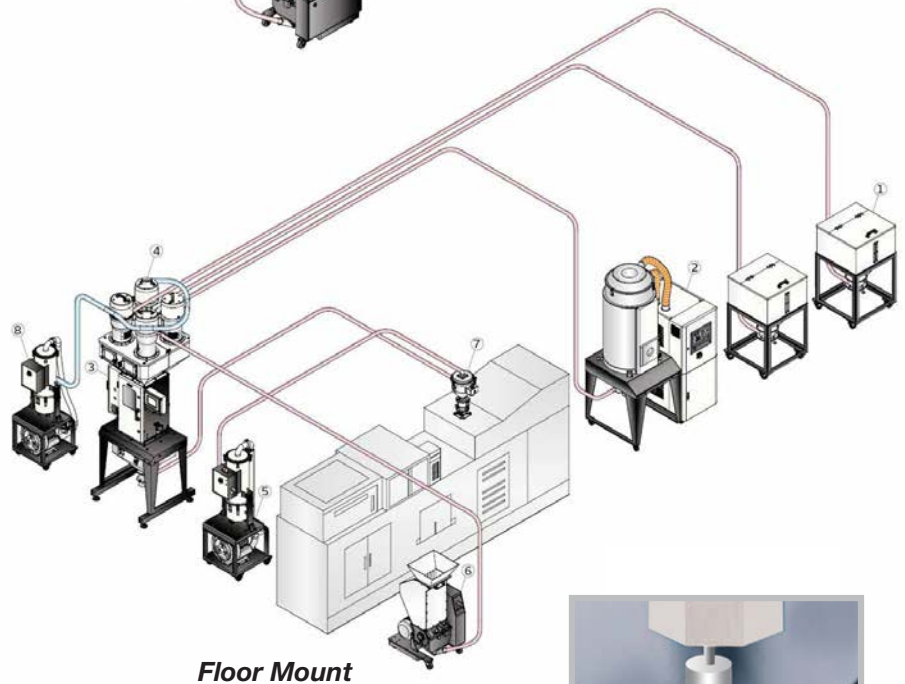

Vertical cone metering valve ensures accurate metering of granules. Only applicable on the models with 441 lbs/hr throughput and above.

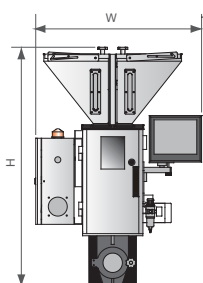

**CGB-40**

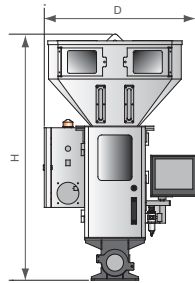

**CGB-200**

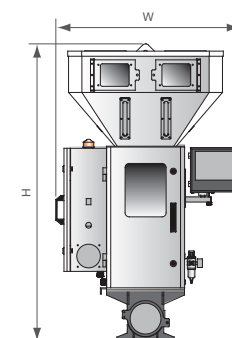
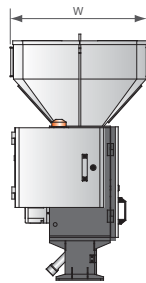

**CGB-600**

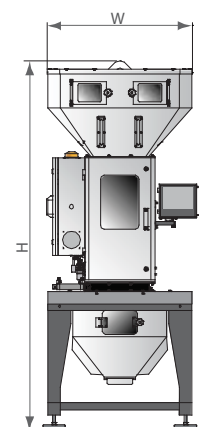
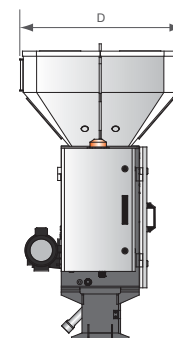

**CGB-1200**

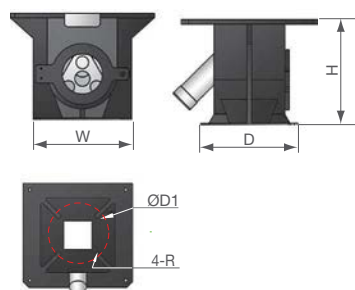
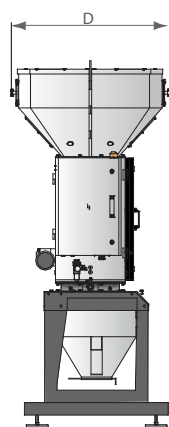

**Magnetic Base**

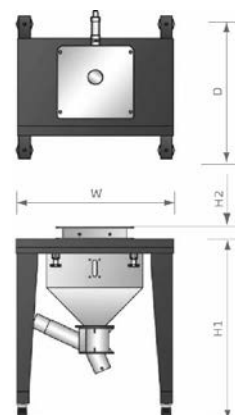

**Floor Stand Assembly**

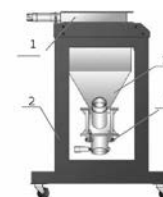

1. Pneumatic shut-off valve
2. Mobile stand
3. Storage bin
4. Suction box

## Specifications

Model	SGB-40-4	SGB-200-4	SGB-600-4	CGB-600-6	CGB-1200-4	CGB-1200-6
Total Capacity Per Hr (lbs)	88	440	1320	881	2645	1984
Number of Gates	4	4	4	6	4	6
Number of Augers	Optional					
Number of Hoppers	4	4	4	6	4	6
Hopper Capacity (lbs)	35	35	60	35	35	60
Blending Motor (HP)	0.3	0.3	0.6	0.7	0.5	0.5
Blending Motor Speed (RPM)	81	81	81	81	81	81
Dimensions (L x W x H (in))	21 x 21 x 34	31 x 28 x 45	40 x 40 x 59	40 x 40 x 59	94.4 x 32 x 40	94.4 x 32 x 40
Mounting Base (in)	10 x 13 x 12	10 x 13 x 12	14 x 14 x 17	14 x 14 x 17	—	—
Shipping Weight (lbs)	225	304	480	485	882	882
<b>Floor Stand, Material Bin &amp; Takeoff</b>						
Floor Stand Size (in)	30 x 26 x 24	36.5 x 28.5 x 31.5	37 x 32 x 31.5	30 x 26 x 24	36.5 x 28.5 x 31.5	37 x 32 x 31.5

We reserve the right to change specifications without prior notice.