

Self-Contained Hopper Loaders

Corrosion-free, stainless steel self-contained hopper loaders are designed to prevent material contamination.

Comet's CAL-U Series self-contained (vacuum) hopper loaders are used to transfer pellets and regrind from a single source (usually a gaylord) to a single destination (usually a blender, drying hopper, or machine throat) in facilities that do not have centralized conveying systems. The cost-efficient, stainless steel hopper ensures contamination free material, and the soundproof motor cover reduces motor noise. The detachable hand-held control panel allows the operator the convenience of remote operation.

Standard Features

- Sound-proof, corrosion free stainless steel interior with no internal protrusions.
- High speed carbon brush motor and fault indicator for a faster rotating speed.
- User-friendly microprocessor control with a fully programmable, easy-to-read interface with functions for filter cleaning time and frequency, load and delay time, and maintenance scheduling.
- Extremely reliable, highly sensitive reed switch on CAL-U or photosensor switch on CAL-U-E for material level detection.
- Quick release, hinged hopper lid ensures quick cleanup time and easy maintenance.
- CAL-6U and above models can select an air accumulator to enhance purging and reduce manual clean time.
- Detachable hand-held control panel for remote operation.
- Run time indicator, reverse stopper flap, automatic cleaning.
- A pendant can be extended up to 50-ft. by using a standard CAT5 cable.
- Cloth mesh filter and auto-spraying dust cleaner.

Options

- Reinforced auto cleaning air accumulator (model CAL-6U and above).
- Regrind mix ratio works with Comet's CPV-U proportioning valve to enhance mixing.
 - Variable load sequences
 - Visual alarms
 - Items include: (1) 10-ft. hose, (2) adjustable clamps, and (1) stainless steel wand.



CAL-6U



CAL-3U-E

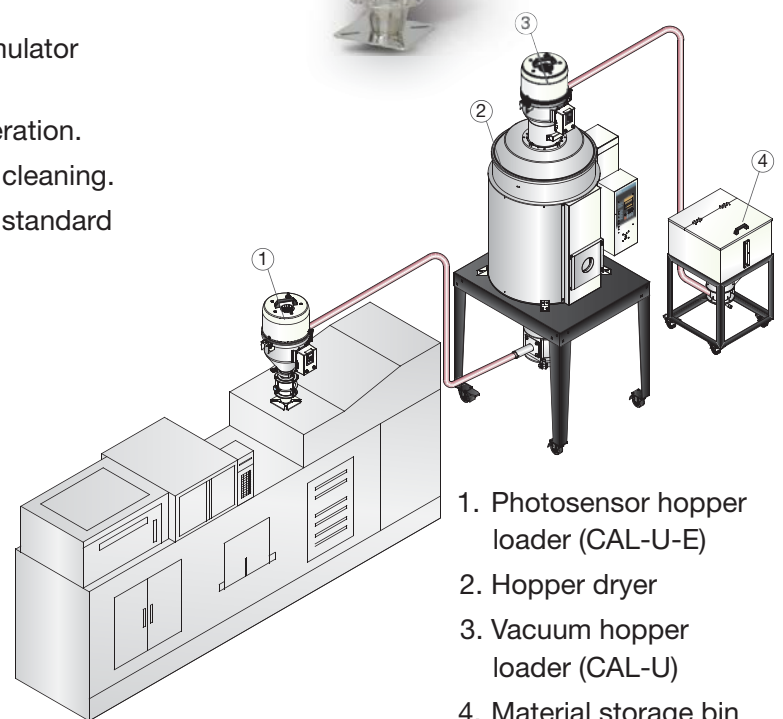

1. Photosensor hopper loader (CAL-U-E)
2. Hopper dryer
3. Vacuum hopper loader (CAL-U)
4. Material storage bin

Loading Capacity

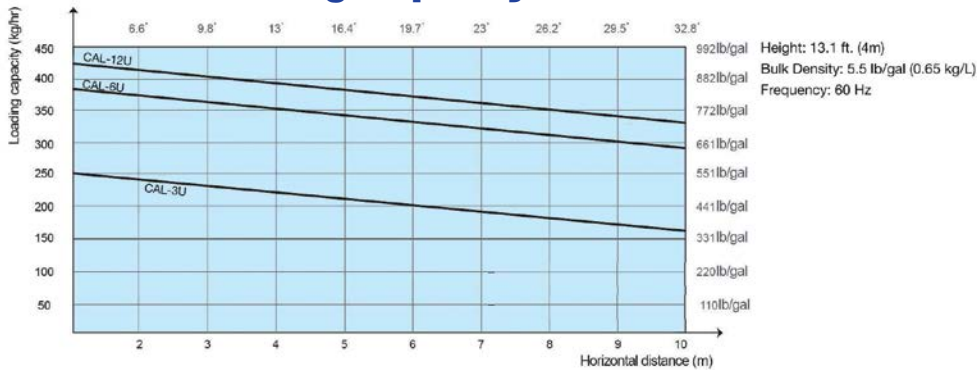

CAL-3U (and above) Hopper Base Installation Size

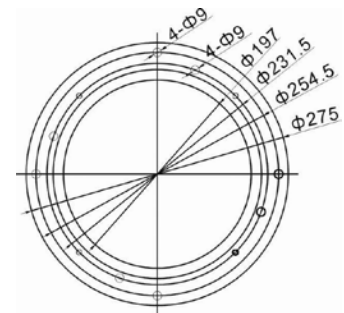

CAL-U-E Hopper Base Installation Size

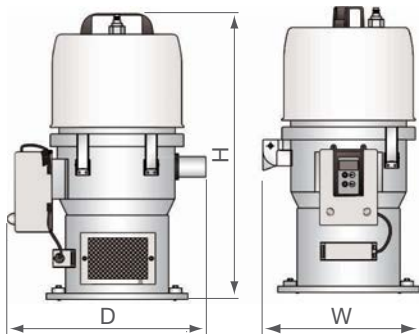
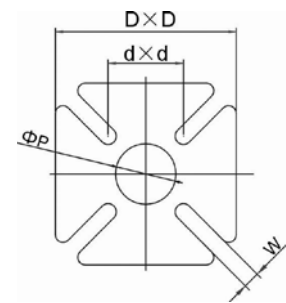

CAL-U

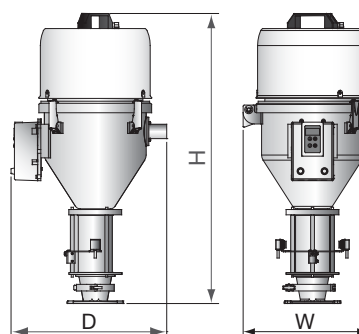

CAL-U-E

Specifications

Model		CAL-3U	CAL-6U	CAL-12U	CAL-3U-E	CAL-6U-E	CAL-12U-E
Motor Type		Carbon Brush					
Motor Power	hp kW, 50/60Hz	1.85 1.15 / 1.32			1.85 1.15 / 1.32		
Level Switch		Proximity Sensor			Glass Tube w/Photosensor Switch		
Conveying Pipe Dia.	inch	1.5					
Conveying Capacity	lbs/hr kg/hr	440 / 550 200 / 250	660 / 845 300 / 383	880 / 935 400 / 425	440 / 550 200 / 250	660 / 845 300 / 383	880 / 935 400 / 425
Hopper Capacity	gal L	.80 3	1.6 6	3.2 12	.80 3	1.6 6	3.4 12

Dimensions

H	inch	22	25	29	29	32	37
	mm	555	645	745	740	800	940
W	inch	12	13	13	12	13	13
	mm	305	340	340	305	340	340
D	inch	15	16	16	15	16	16
	mm	370	410	410	370	410	410
Weight	lb	24	27	31	29	35	40
	kg	11	12	14	13	16	18

Note: Conveying Capacity Test Conditions:

1. Bulk density of plastic material: 5.5 lb/gal. (0.65kg/L)
2. Diameter: 0.12~2 inch (3~5mm)
3. Vertical conveying height: 13.1 ft. (4m)
4. Horizontal conveying distance: 3.28 ft. (1m)
5. Compressed air supply: 4~6 kgf/cm²
6. Power Supply: 1Ø, 115/230VAC, 50/60Hz

We reserve the right to change specifications without prior notice.